

bre



ForestValue

CLICK*design* - delivering fingertip knowledge to enable service life performance specification of wood

Dr Ed Suttie, BRE





- Struggle to answer questions about durability and performance of wood products
- Disadvantage for timber compared to steel, aluminium, plastic and concrete
- Technical specifications in Building Information Modelling (BIM) and life cycle analysis (LCA) include service life data
- Wrong product, wrong place

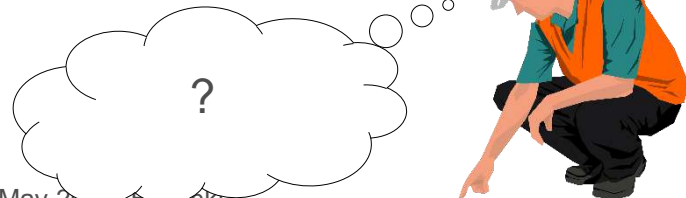

-
- A software tool for architects and specifiers to embed service life performance specification for wood.
 - From the complex, fragmented and general to the easy-to-use, consolidated and specific in an accessible digital tool.
 - The CLICKdesign tool will combine within it the decades of research, the complexity of the standards specification and the variation of approach due to tradition, materials and culture across Europe.
 - March 2019 to February 2022



CLICK DESIGN *delivering fingertip knowledge to enable service life performance specification of wood*



With European consumer expectations and construction professional direct input the project will develop a tool to enable appropriate digital specification of wood in construction based on a performance requirement that integrates material integrity (decay and termites) and aesthetic qualities.



Partner	Name	Country	Type*
P10	Cordes Holzbau	D	ENG
P11	Miebach	D	ENG
P12	WPA	UK	TA
P13	Architype	UK	ARC
P14	Barnsdales	UK	MAN
P15	Limträteknik i Falun	SE	ENG
P16	TMF	SE	TA
P17	Swedish Wood	SE	TA
P18	BDZ	D	TA
P19	Kebony	N	MAN
P20	TreFokus	N	MAN
P21	Liikennevirasto	FI	PA
P22	BASF Wolman	D	MAN
P23	Puutuo- teteollisuus	FI	TA
P24	Stora Enso	FI	MAN
P25	FPI Innovations	Canada	RES
P26	Jelovica dd	SLO	MAN

CORDES
HOLZBAU

MIEBACH
INGENIEURBÜRO

WPA
Wood Protection Association

ARCHITYPE

GEORGE
BARNSDALE
Est. 1884

Limträteknik AB

tmf
SWEDISH FEDERATION OF
WOOD AND FURNITURE INDUSTRY

SWEDISH
WOOD

HOLZBAU
DEUTSCHLAND
BUND DEUTSCHER
ZIMMERMEISTER

ke
bo
ny

TreFokus

Liik
enne
vira
sto

Wolman
by BASF - We create chemistry
Leading the Way in Wood Protection

storaenso

JELOVICA

Hygiène Office

Puutuoteteollisuus

- Exposure model
- Decay model
- Resistance model
- Insect model
- Aesthetics model
- Strength model

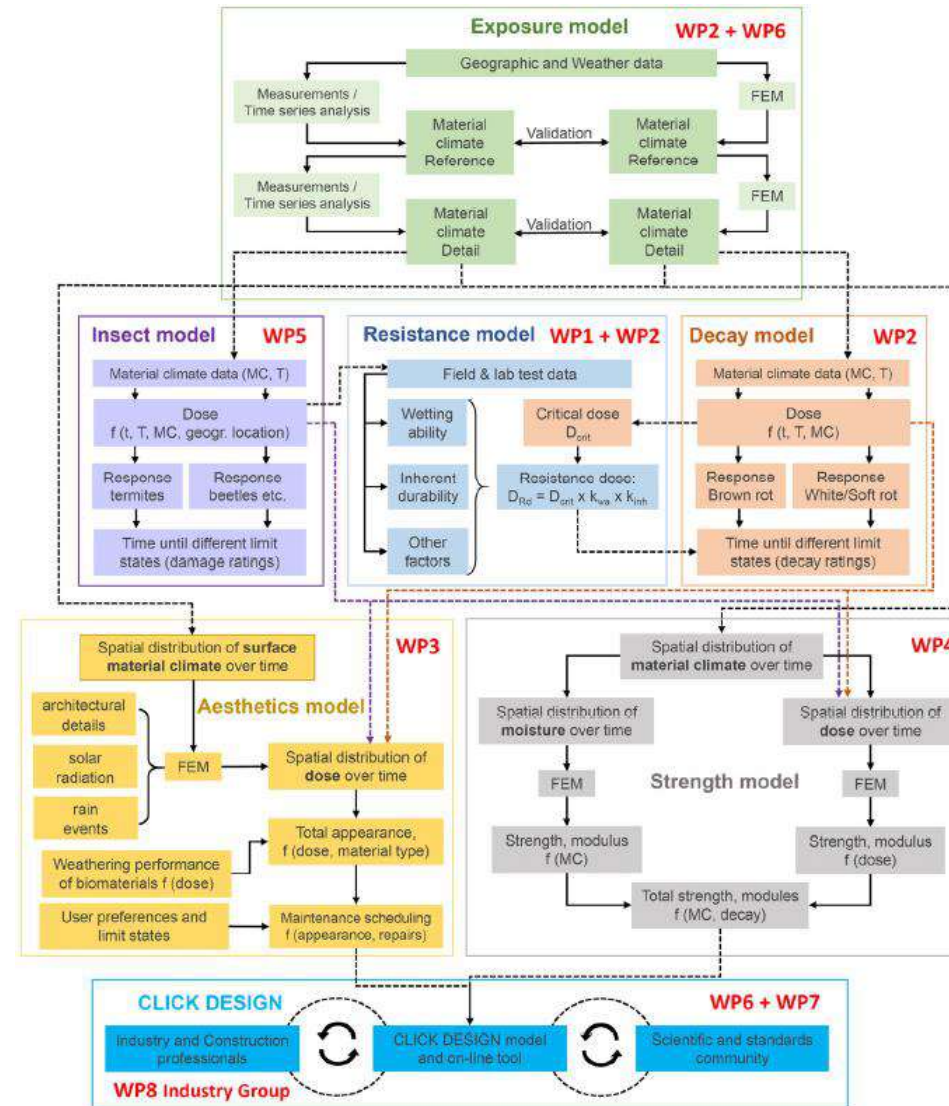

Decay, insect and aesthetics

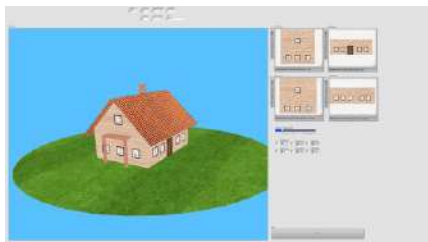
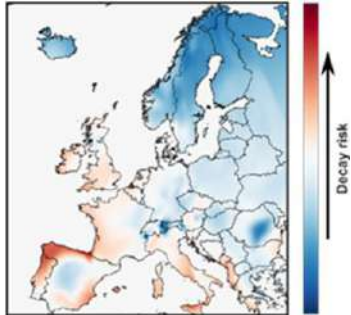

Construction

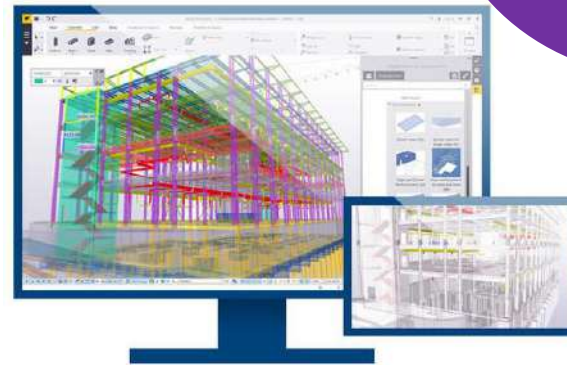
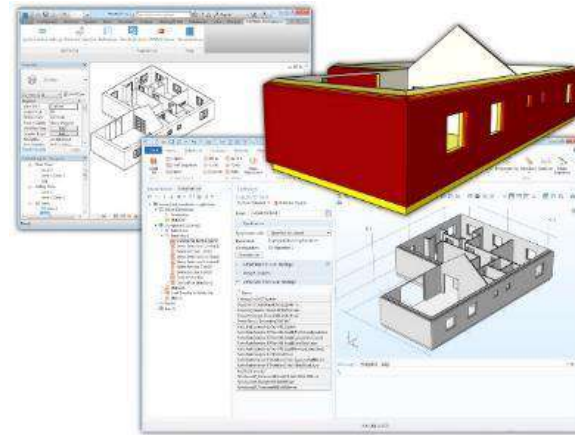

Validation

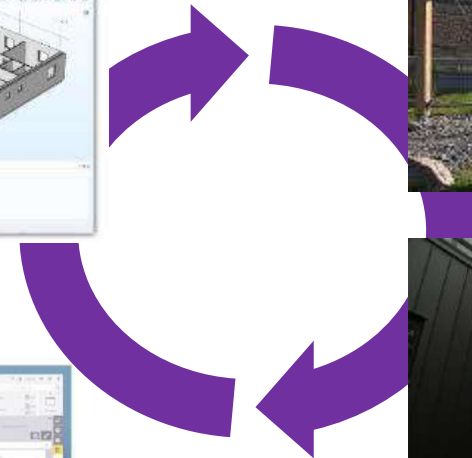
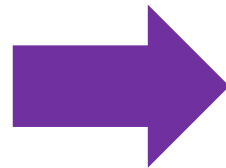

Construction professionals



Forest based industries



Standards and Authorities



Citizens



Exploitation

Professional tool

Transnational communication
 Training and education
 Workshops
 Validation pilots and case studies
 Input to standards committees
 ISO/TC59/SC14 CEN/TC38

Public tool

Social media conversations
 Campaign support
 How long will it last?

Research Organisations



Industry Group



- **Increase market confidence** with users for selecting wood as a **reliable product** and enhance an optimised performance of timber in the built environment
- A **resilient future** - adaptable for features not integrated into specification now such as significant variations due to climate change
- **Inspiring new wood and wood-based products** using performance based specification
- Improved **technical specifications** for BIM and LCA
- In the right language so more can meet ambitions to **deliver low carbon construction**, through performance based specification with wood
- Supports “**fit for purpose**” product specification public awareness and understanding
- Reaching **beyond timber savvy** construction professionals



ForestValue project CLICKdesign

Project CLICKdesign is supported under the umbrella of ERA-NET Cofund ForestValue by the Ministry of Education, Science and Sport (MIZS) - Slovenia; The Ministry of the Environment (YM) - Finland; The Forestry Commissioners (FC) - UK; Research Council of Norway (RCN) - Norway; The French Environment & Energy Management Agency (ADEME) and The French National Research Agency (ANR) - France; The Swedish Research Council for Environment, Agricultural Sciences and Spatial Planning (FORMAS), Swedish Energy Agency (SWEA), Swedish Governmental Agency for Innovation Systems (Vinnova) - Sweden; Federal Ministry of Food and Agriculture (BMEL) and Agency for Renewable Resources (FNR) - Germany. ForestValue has received funding from the European Union's Horizon 2020 research and innovation programme under grant agreement N° 773324.